

SYDNEY THEATRE CO



Wharf 2 Theatre Technical Specifications

Sydney Theatre Company
Wharf 4/5 15 Hickson Rd
Walsh Bay, NSW, 2000

The information contained in this document is based on current information as of July 2024. While every effort is made to be as specific and as accurate as possible some changes may occur.

Please direct all enquiries to venuemanager@sydneytheatre.com.au
Phone: + 61 2 9250 1908

Contents

General Information.....	3
Stage Specification.....	4
Staging Accessories.....	6
Lighting Facilities.....	7
Sound Equipment.....	9
Audio Visual Equipment.....	9
Communications.....	10
Backstage Facilities.....	10
Safety.....	11
Other Information.....	12

General Information

The Wharf 2 Theatre is a studio theatre with a fixed grid, and a retractable seating bank.

Capacity: 161

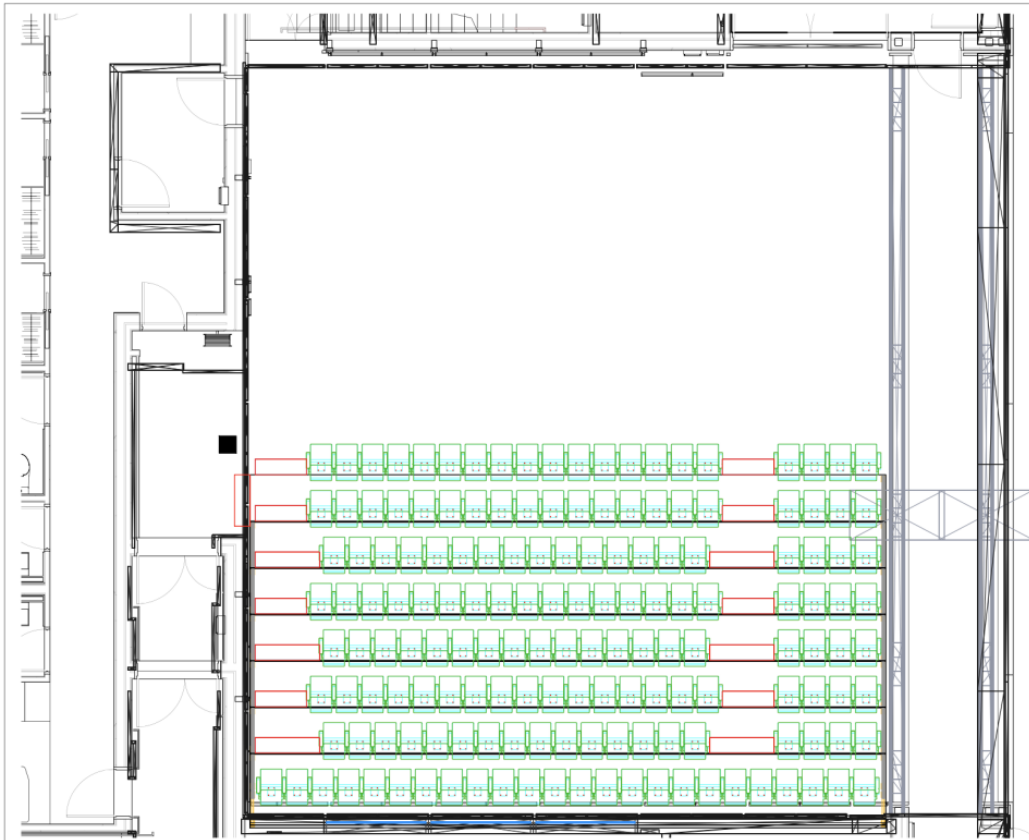

Accessibility

The auditorium and backstage areas are wheelchair accessible.

Load-in Area

The Loading Dock of the Wharf is accessible during approved building operation hours of 700am to 12.00am from Pottinger St. Maximum allowable vehicle is 19m (30T GVM) articulated vehicles that reverses in. If vehicles over 8.8T are required, local residents must be notified. Trucks must be unloaded manually or by forklift as there is no dock height. Trolleys are available to then transfer scenery through the workshop and into the backstage corridor into Wharf 1. A fork lift can be driven from the loading dock through the backstage corridor and to the Wharf 1 door. The doors from the backstage corridor into Wharf 1 stage are 5100mm high by 2760mm wide and the backstage corridor is 5m wide and level to the stage floor. Any large scenic elements must be checked with the Technical Manager or Production Manager before construction to confirm they can fit through these doors.



Storage Space

There is limited storage space in the venue. Some space may be negotiated under the seats backstage but access for the cast and crew needs to be maintained at all times. Please be aware that no flammable materials should be stored under the seats at any time. Storage of road cases, etc., if required, can be negotiated in the dock area.

Stage Specifications

A 2400mm clearance from the back edge of the first seat to scenery (including show floor) must be maintained to allow audience egress.

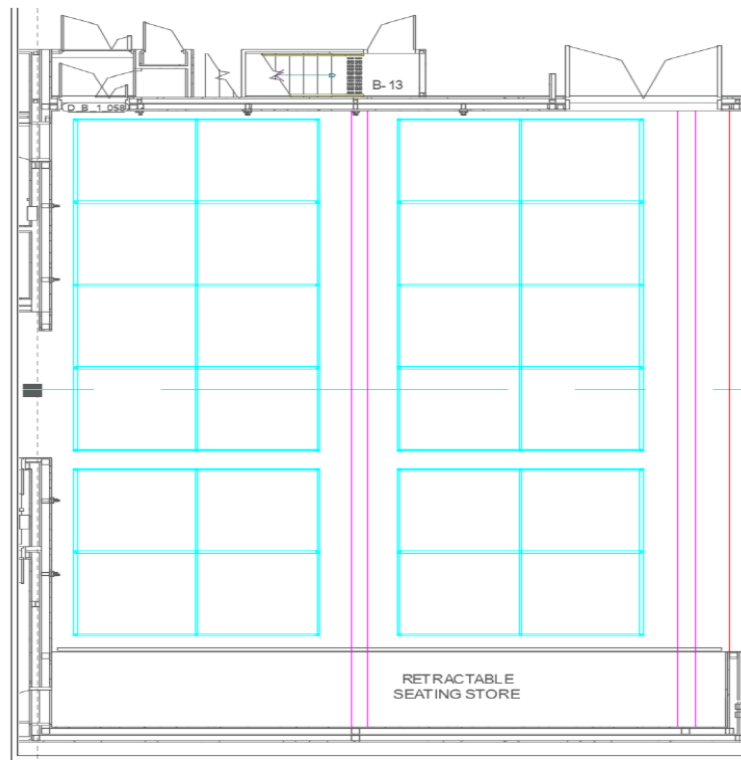

Stage Dimensions

Length (North/South):	12400mm
Width (East/West):	14400mm
Setting line to rear wall:	5700mm

Grid Height

Grid height:	6000mm
Maximum scenery height:	5500mm

Fire Safety

For Wharf 2, the maximum built stage should cover no more than 50m².

Immovable set items such as ceiling pieces hung above the stage cannot obstruct the fire sprinklers. Such items should be no wider than 800mm and finished with a surface that is permeable by water.

Stage Floor

The stage surface consists of two layers of 19mm ply on a floating acoustic concrete slab. A 9mm weathertex overlay, painted a satin black, is the standard surface. Scenery can be screwed down into the floor, maximum screw depth of 40mm.

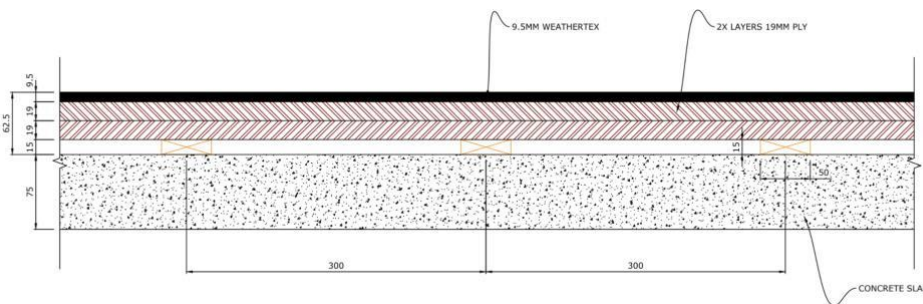

Maximum Loadings

Stage: Live Load Uniformly distributed 750kg/m²
Point load of 450kg/m²

Grid (W2): 50kg per metre distributed load on truss grid
I-Beam has 600kg point load or a total capacity of 1T per beam
Total Weight limit in Wharf 2 is 2500kg

Notes: Vertical Unistrut 500 kg concentrated load per vertical, 50kg per metre distributed load
Horizontal Unistrut 50 kg per metre distributed load

Staging Accessories

Masking

There is no standard masking installation in the Wharf 2 Theatre. Please check availability of the masking with the Technical Manager or the Head Mechanist, as it is not venue specific stock.

Rostra

STC owns approx. 120 x 2m x 1m steel framed rostra, which can be set at variable heights. Leg heights must be specified prior to bump in and associated charges will be passed onto the production.

Height Access

STC owns a Haulotte Star 10 and Genie GR20 for height access during bump-ins. Maximum working height is 10m. STC also has a stock of various ladders available for use.

Other

Various forms of tracking are available upon request. Please check with the Head Mechanist or the Technical Manager for availability, lengths, etc.

Lighting Facilities

Control

ETC Ion XE with 6000 DMX channels, located in Control Room
ETC ION as backup

Dimming

108 x 2.4 kW dimmers. All dimmers can be configured as DMX relays.
60 Dimmers are used for the standard rig.

Data Distribution

Network DMX via sACN from lighting console.
Pathport Octo node distributes DMX to truss pods. Multiple 5-pin DMX outlets are available per truss pod, and in various floor locations.

Rigging

4 fixed grids at approximately 5.2m trim height.

Plans are available upon request for more information

Access

Genie GR-20 Self-Driving Elevated Work Platform

Please note, only STC staff members are permitted to operate EWP.

Standard Equipment:

LAMPS	
Description	Units
Selecon SPX 15/35	44
Selecon SPX 25/50	24
Selecon Rama Fresnel	24
Selecon Acclaim Fresnel	10

ACCESSORIES	
Description	Units
Selecon SPX Iris	10
Selecon SPX B Size Gobo Holder	20
Selecon SPX B Size Glass Gobo Holder	10

Standard Rig

Please note the Standard Rig utilises the following equipment from the above list

LAMPS	
Description	Units
Selecon SPX 15/35	22
Selecon SPX 25/50	10
Selecon Rama Fresnel	20
Selecon Acclaim Fresnel	10

The Standard Rig plan is available upon request, and include the following systems:

1. Full room warm wash for cocktail events or similar.
2. Full stage front face light wash.
3. Full stage backlight blue and amber wash.
4. Full stage gobo breakup wash
5. Specials for lectern, bars, piano's, flowers, plinths, etc,

NOTE: Specials are permitted to be focused for event specifics at no additional charge.

Please Note

Standard rig equipment shall not be moved unless agreed to prior to booking.

Any changes to the standard rig will need to be reset, at the cost of the hirer.

Patching

The dimmer room is located on level 3 on the North side of the theatre adjacent to the control room. Ethernet and DMX patching is available throughout grid and backstage area. Additional path port nodes are available from floating stock. Various lengths and configurations or Socapex available.

Floating Equipment

The lighting department has some extra fixtures and equipment available for use at an extra charge. For a current list of this equipment please contact the Head of Lighting. Use and availability of this equipment is at the discretion of the Head of Lighting.

Sound Equipment

Below is a list of sound equipment allocated to the Wharf 2 Venue.

	Qty	Notes
Console		
Digico SD11I Mixing Console	1	Software Version 11.43 + Waves enabled
Playback		
Mac Mini 2.7Ghz Dual-Core with Qlab Pro Bundle	2	Qlab v4
Waves MGB Digigrd Madi Audio interface	2	
Waves impact server	1	
Various waves Plugins	1	C6, Q10, H-Verb & Dan Dougan
Speakers & Processing		
Nexo PS15 R2 Loudspeaker	2	Main L+R system
Yamaha 4x4 Nexo Amp	1	Low Frequency Amplifier
Nexo RS-18	1	Subwoofer
Tie Lines & Distribution		
8 way Van Damme multipin balanced distribution	#	
Venue wide Male & Female XLR distribution	#	
Venue wide SDI distribution	#	
Venue wide Cat-6 Ethernet distribution	#	
Power		
Dedicated sound power throughout venue		
Powerware 9390 40kVA 3-Phase UPS	1	
Eaton Premium power filter	1	

Floating Equipment

The sound & Video department has other equipment available for use at an extra charge. For a current list of this equipment please contact the Sound & Video Supervisor.

Audio Visual Equipment

The Wharf 1 Theatre does not have any permanent video infrastructure or allocation of equipment. The company has a supply of floating video equipment available for use at an extra charge. For a current list of this equipment please contact the Sound & Video Supervisor.

Communications

Talkback System

	Qty	Notes
Clear-Com, 2 ch. Partyline Base Station (MS-702)	1	
Clear-Com Wired Belt pack, Single channel (RS-601)	6	
Clear-Com Freespeak II Base Station (FSII-BASE)	1	We have 8x antennae distributed throughout the building with increased density in the theatres for solid coverage.
Clear-Com Freespeak II Wireless Belt pack (BP19X4)	6	Includes 2x batteries per beltpack

Cue Light System

Leon 6 channel Master Station (QLM8 Mk3)	1
Leon Standard Outstation (QLS-B Mk3)	6

Stage Relay

Stage audio relay and FOH Stage HD Camera feed and low light are available to the dressing rooms and control room. Additional audio or camera feeds can be installed as required. Please discuss and make these arrangements with the Sound & Video Supervisor.

Backstage Facilities

Wharf 2 has three Dressing Rooms with a total capacity of eight performers. There are toilet and shower facilities. A small laundry with 1 x washer and 1 x dryer are available. There is also a private tea prep room.

Safety

The Sydney Theatre Company is committed to ensuring the health and safety of all staff, contractors, visiting staff and patrons. The Sydney Theatre Company undertakes to comply with all Work, Health and Safety legislation and regulations. This legislation will be viewed as the minimum standard. A Risk Assessment must be carried out on each production.

All design aspects need to be created in a way that is appropriate to the level of activity undertaken and does not pose a risk to the health and safety of its users (including working at heights, manual handling, and noise levels). This applies to all aspects of design for STC productions including, sets, props, costumes, lighting, and sound covering the production period, rehearsals, bump-in and season.

All scenery must be designed and built in accordance with the licensing and building code requirements that pertain to the venue. Set items must be of a suitable size and weight appropriate to the amount of handling and size of transportation facilities available. Set pieces on which performers are to perform and which exceeds two metres must comply with the building code of Australia.

All specified set materials should be treated with fire retardant or able to be effectively treated with approved fire-retardant coatings. Where this is not possible, e.g., certain synthetic material, the use of such material may be possible subject to an effective risk management plan. In certain cases, this plan may require approval by the Building Services Manager in consultation with the relevant licensing authorities. Please raise any such issues as early as possible.

Emergency exits, egress routes and signage must be maintained. These zones are usually indicated in the venue plans, but the Technical Manager or Production Manager can provide you with more information before you begin your design.

To assist us in ensuring a safe working environment for all staff, contractors, visitors and patrons, the Sydney Theatre Company requires that all electrical equipment brought on to site must have been electrically checked and possess a clearly displayed current test and tag label (as specified in Australian/New Zealand Standard 3760). Any equipment not in current test period, clearly tagged or deemed unsafe will be removed from service immediately.

Sound exposure limits for unprotected ears to audio effects and music onstage and in the auditorium are subject to a risk assessment (85db or above). Limits are subject to review after consultation by employees or audience members and may require expert counsel in relation to audiometric testing and advice. Sydney Theatre Company staff must be present during all work done in its venues and workshops to ensure the safety of all. All staff whether visitors or contractors must be inducted and sign the relevant Safe Work Procedure document before using any plant or equipment on the Sydney Theatre Company premises.

Please do not hesitate to contact the relevant Department Head or Manager for more information.

Other Information

STC staff work under the Sydney Theatre Company Theatrical Employees Enterprise Agreement. Any schedules should be formulated with this agreement in mind, i.e. breaks, penalties, etc. Please do not hesitate to contact the relevant Department Manager for more information.

Wharf 2 has addressable Carbon Monoxide (CO) detectors, which can be isolated for hot works subject to approval. There is a mimic panel for the fire alarm system on the public walkway adjacent to administration.

Wharf 2 has an Induction Loop installed for hearing impaired patrons. Headsets are available from FOH staff.

Various tables are available for props. Please check for availability.

There is limited parking available to show staff. Parking must be negotiated with House Services either directly or via the Stage Manager. Alternatively, there is metered parking on Hickson Rd. Also, Circular Quay train station is 15 minutes walk and there are taxis available on Hickson Rd.

Cafes and restaurants are all available within a short walk of the Wharf. The Bar at the End of the Wharf is also available for lunch and dinner.

Standard building opening hours are 8.00am to 12.00am Monday to Friday and 10.30am to 12.00am Saturday. Access outside these hours must be negotiated and will incur overtime penalties.